



NCHU Male Dormitory



SDSC 12th

Outline



Office



Rooms



Facilities



Caution



Security

Map

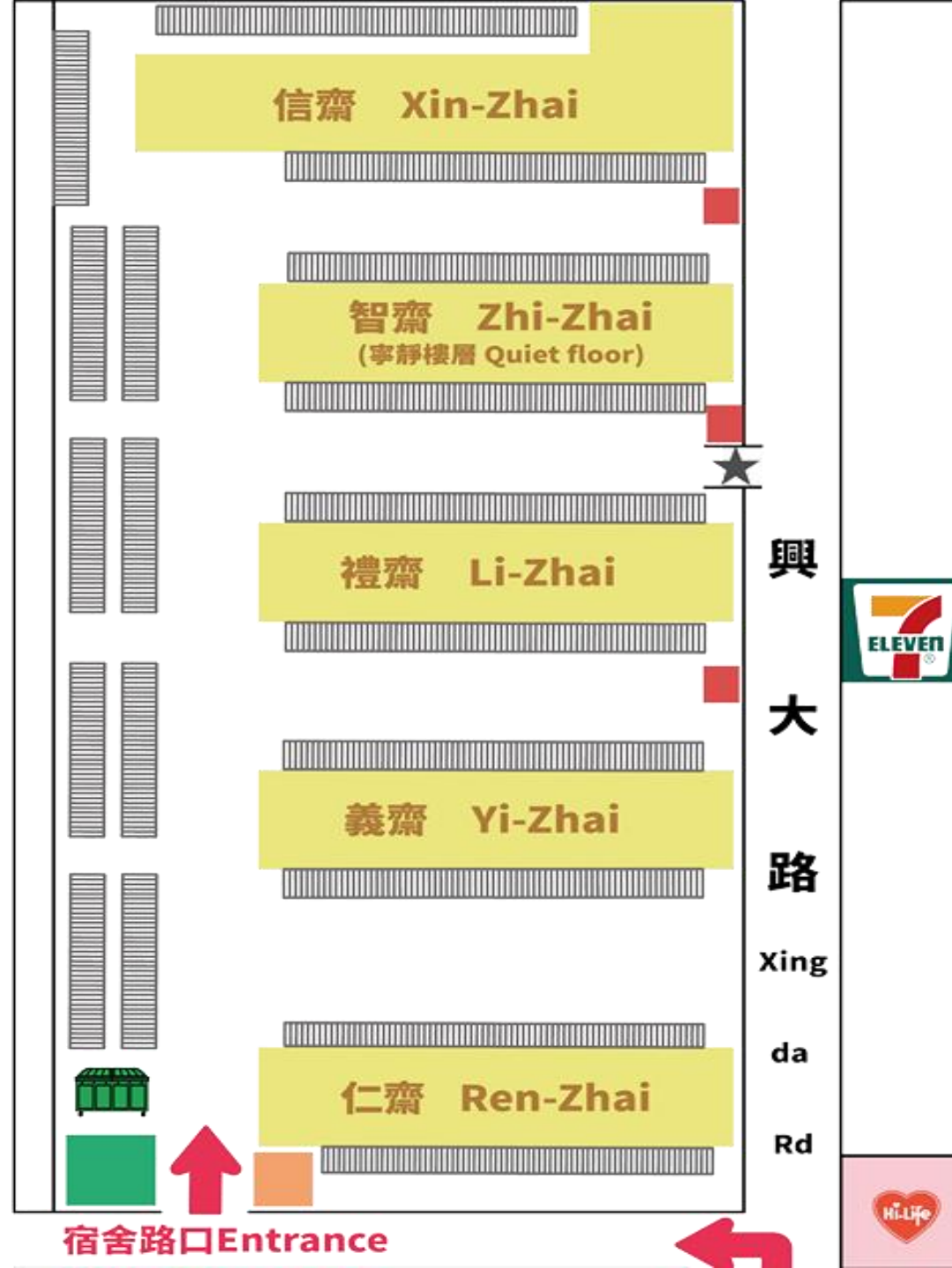

Service Center:



Security Room:



Smoking Area:



Second Entrance:
(6:00 – 22:00)



Office



Security Room



- Emergency Assistance
- Air conditioner card deposit
- Tire Inflation (self-service)
- Package & Registered Mail Receiving
- Spare Keys Borrowing

Office hour: 24Hrs

Phone: 04-22870475

Service Center

- Applications Related to the Dormitory (e.g. moving in, leaving)
- Ordinary Mail Receiving
- Further Affairs Related to the Dormitory

Contact Us:

Email: maledormitory@nchu.edu.tw

Phone: 04-22870724, 04-22840473

Office Hour:

Mon - Tues : 8:30 – 12:30, 13:30-21:00

Fri: 8:30 – 12:30, 13:30-17:00



Postal Address

E.g.

000 ----- Name

Room 3433, Li-Zhai --- Room No., Buildings

National Chung Hsing University

Male-student Dormitory,

Xinda Road 145, South District, Taichung City, 402

(Please remember to indicate your building, room number, name and cell phone number in the receiving area.)

Rooms



Inside the Room



- Each room will be divided into 4 beds. That is, there will be 4 students in a room. Each bed will be marked in A, B, C, D.
- Each bed includes a desk, a chair, a wardrobe, a bed, a headlight, bookcases, sockets and internet access. (Cable should be prepared by students.)
- Please pay attention to your number while moving in the dormitory.

Rooms in Yi Zhia



Rooms in Li Zhia



Rooms

Bathrooms



Rooms --- Public Area

- Each Floor includes a water dispenser, two washing machines, a dryer and spin dryers.

- Price:

Washing machine: NT 20\$/per time

Dryer: NT 10\$/30 minutes

Spin dryer: Free

Rooms --- Public Area



Water Dispenser



Recycle Area

Rooms --- Public Area



Spin Dryer& Washing Machine



Dryer

Notice

- The dormitory regulations are on the back of the door, please follow the rules.
- We've provided an English version on the website, please see the regulations if you cannot recognize Chinese.
- If the bedroom needs to be repaired, you can request online for repair.

Procedure: NCHU SSO => Academic Info. System => Student Dormitory => Dormitory
Online Repair System

Facility



Ren-Zhia

Sport Area
(Basement)



Billiard



Table Tennis

Li-Zhia
Kitchen &
Lounge
(Basement)



Kitchen



Lounge

Zhi-Zhia Study Room (Basement)



Caution



Caution



- No Alcohol in the Dormitory.
- No Smoking in the Dormitory.
(Despite the smoking area)
- Low Down your Volume after 10 pm



Caution



Don't Use the Socket in the Public Area

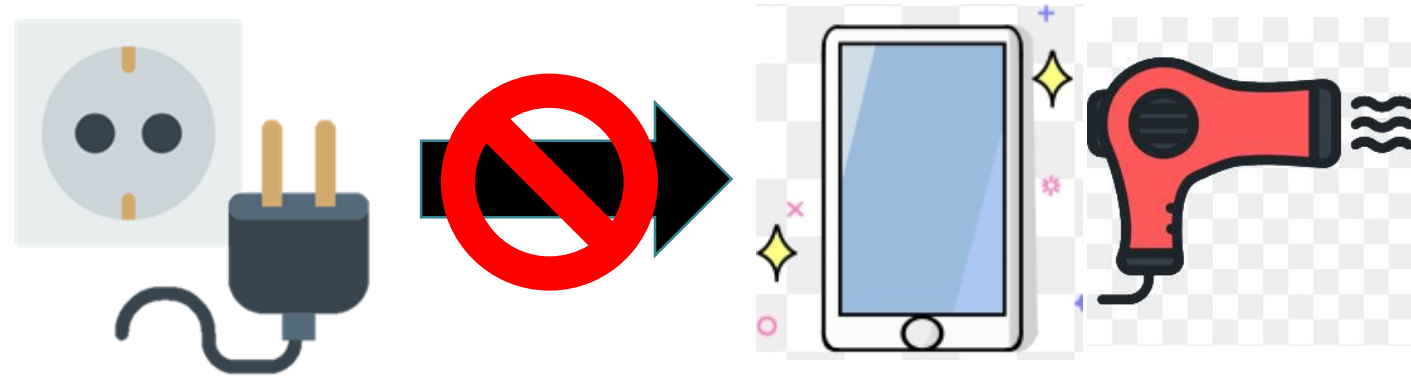

All the Machines can't be Used after 12 pm

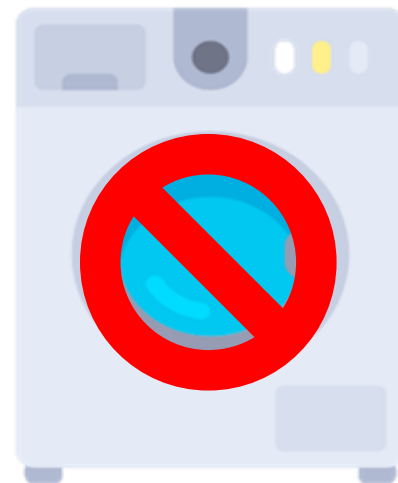

After 00:00

Caution



No Food Scrape in the Water Dispenser



Caution



Please Recycle Properly in the Public Recycle Bin & Put Your Personal Rubbish (E.g. Tissue) in the Dumpster (next to the service center)



Security



Entry Access Control

- Students should have an access card (student ID card) or a temporary access card (can be borrowed from the security room) to enter the buildings by tapping the access controller.
- The gate is closed at 00:30-06:00 every night. Students should use their student ID card to enter the dormitory. (By tapping the access controller)

Emergency Calls

Service Center: 04-22870724, 04-22840473 (Office Hour)

Security Room: 04-22840475 (0:00 - 7:00)

Office of Military Education: 04-22870885 (0:00 - 7:00)

Thanks for your attention

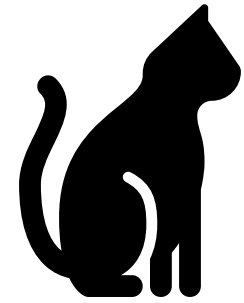

SDSC 12th